

ARMSTRONG® 11 Pc. 1/4" Drive 6 Point SAE Impact Socket Set

- Made in the USA - Quality and Availability
- Radius Corner Design Engages the Flats of the Fastener, Not the Corners, Providing Up to 15%-20% More Torque While Reducing Fastener Rounding, Enhancing the Turning of Worn Fasteners
- EYE-D™ Markings Optimize Size Visibility, Also Providing SAE / Metric Differentiation
- Socket Wall Dimensions Are Optimized to Provide Strength While Retaining Access to Restricted Fasteners
- Manufactured From High Alloy Steel Using the Most Up-To-Date Manufacturing Process and Heat Treat for Greater Strength and Durability
- Meets or Exceeds ASME Specification B107.2-2002 and US Federal Specification GGG-W-660a



Cat. No.	UPC No.	Packaging	Product Weight	Shelf Pack Qty.
18-890	781412188905	Boxed	0.63 lb	1

Cat. No.	Description	Cat. No.	Description
16-831	9" Socket Rail Steel	18-611	1/4" Drive 6 Point Impact Socket 11/32"
16-841	1/4" Drive Socket Clips Steel	18-612	1/4" Drive 6 Point Impact Socket 3/8"
18-606	1/4" Drive 6 Point Impact Socket 3/16"	18-614	1/4" Drive 6 Point Impact Socket 7/16"
18-607	1/4" Drive 6 Point Impact Socket 7/32"	18-616	1/4" Drive 6 Point Impact Socket 1/2"
18-608	1/4" Drive 6 Point Impact Socket 1/4"	18-618	1/4" Drive 6 Point Impact Socket 9/16"
18-609	1/4" Drive 6 Point Impact Socket 9/32"	18-620	1/4" Drive 6 Point Impact Socket 5/8"
18-610	1/4" Drive 6 Point Impact Socket 5/16"		

ARMSTRONG® 12 Pc. 1/4" Drive 6 Point Metric Impact Socket Set

- Made in the USA - Quality and Availability
- Radius Corner Design Engages the Flats of the Fastener, Not the Corners, Providing Up to 15%-20% More Torque While Reducing Fastener Rounding, Enhancing the Turning of Worn Fasteners
- EYE-D™ Markings Optimize Size Visibility, Also Providing SAE / Metric Differentiation
- Socket Wall Dimensions Are Optimized to Provide Strength While Retaining Access to Restricted Fasteners
- Manufactured From High Alloy Steel Using the Most Up-To-Date Manufacturing Process and Heat Treat for Greater Strength and Durability
- Meets or Exceeds ASME Specification B107.33M-2002



Cat. No.	UPC No.	Packaging	Product Weight	Shelf Pack Qty.
45-890	781412458909	Boxed	0.73 lb	1

Cat. No.	Description	Cat. No.	Description
16-831	9" Socket Rail Steel	45-009	1/4" Drive 6 Point Impact Socket 9mm
16-841	1/4" Drive Socket Clips Steel	45-010	1/4" Drive 6 Point Impact Socket 10mm
45-004	1/4" Drive 6 Point Impact Socket 4mm	45-011	1/4" Drive 6 Point Impact Socket 11mm
45-005	1/4" Drive 6 Point Impact Socket 5mm	45-012	1/4" Drive 6 Point Impact Socket 12mm
45-083	1/4" Drive 6 Point Impact Socket 5.5mm	45-013	1/4" Drive 6 Point Impact Socket 13mm
45-006	1/4" Drive 6 Point Impact Socket 6mm	45-014	1/4" Drive 6 Point Impact Socket 14mm
45-007	1/4" Drive 6 Point Impact Socket 7mm	45-015	1/4" Drive 6 Point Impact Socket 15mm
45-008	1/4" Drive 6 Point Impact Socket 8mm		

ARMSTRONG® 5 Pc. 1/4" Drive Impact Locking Extension Set

- Incorporates a Pin on the Square Drive Providing Maximum Security Against Accidental Disengagement of the Socket, Safety
- Socket is Securely Locked to the Extension and Will Not Disengage Until Knurled Sleeve is Pulled, Safety and Convenience
- Manufactured From High Alloy Steel Using the Most Up-To-Date Manufacturing Process and Heat Treat for Greater Strength and Durability



Cat. No.	UPC No.	Packaging	Male Drive Size	Female Drive Size	Product Weight	Shelf Pack Qty.
18-940	781412189407	Boxed	1/4"	1/4"	0.75 lb	1

Cat. No.	Description	Cat. No.	Description
18-935	1/4" Drive Impact Locking Extension 3"	18-938	1/4" Drive Impact Locking Extension 18"
18-936	1/4" Drive Impact Locking Extension 6"	18-939	1/4" Drive Impact Locking Extension 24"
18-937	1/4" Drive Impact Locking Extension 12"		

ARMSTRONG® 1/4" Drive Power Extensions

- Made in the USA - Quality and Availability
- Incorporates a Pin on the Square Drive Providing Maximum Security Against Accidental Disengagement of the Socket, Safety
- Manufactured From High Alloy Steel Using the Most Up-To-Date Manufacturing Process and Heat Treat for Greater Strength and Durability



Cat. No.	UPC No.	Packaging	Male Drive Size	Female Drive Size	Overall Length	Product Weight	Shelf Pack Qty.
18-921	781412189216	Bagged	1/4"	1/4"	2.000 in	0.05 lb	1
18-923	781412189230	Bagged	1/4"	1/4"	6.000 in	0.15 lb	1

ARMSTRONG® 1/4" Drive Locking Impact Extension

- Made in the USA - Quality and Availability
- Incorporates a Pin on the Square Drive Providing Maximum Security Against Accidental Disengagement of the Socket, Safety
- Socket is Securely Locked to the Extension and Will Not Disengage Until Knurled Sleeve is Pulled, Safety and Convenience
- Manufactured From High Alloy Steel Using the Most Up-To-Date Manufacturing Process and Heat Treat for Greater Strength and Durability



Cat. No.	UPC No.	Packaging	Male Drive Size	Female Drive Size	Overall Length	Product Weight	Shelf Pack Qty.
18-935	781412189353	Bagged	1/4"	1/4"	3.000 in	0.10 lb	1
18-936	781412189360	Bagged	1/4"	1/4"	6.000 in	0.20 lb	1
18-937	781412189377	Bagged	1/4"	1/4"	12.000 in	0.40 lb	1
18-938	781412189384	Bagged	1/4"	1/4"	18.000 in	0.57 lb	1
18-939	781412189391	Bagged	1/4"	1/4"	24.000 in	0.76 lb	1

1 / 4 "

4

IMPACT SOCKETS

ARMSTRONG® 1/4" Drive 6 Point SAE Thin Wall Power Sockets

- Made in the USA - Quality and Availability
- Designed for Use with Electric or Air Driven Power Tools; Not for Use with Impact Power Tools
- Higher Hardness is Designed to Reduce Surface Wear When Used to Turn Hardened Fasteners, Thin Wall Design for Access to Restricted Fasteners
- Socket Wall Dimensions Are Optimized to Provide Strength While Retaining Access to Restricted Fasteners
- Manufactured From High Alloy Steel Using the Most Up-To-Date Manufacturing Process and Heat Treat for Greater Strength and Durability
- Meets or Exceeds ASME B107.3 and US Federal Spec. GGG-W-660A

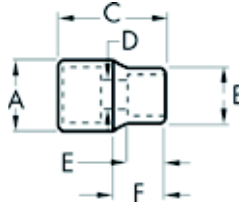

Cat. No.	UPC No.	Packaging	Fastener Size	Dim. A: Drive End	Dim. B: Wrench End	Dim. C: Overall Length	Dim. D: Bolt Clearance	Dim. E: Wrench Depth	Dim. F: Length to Shoulder	Product Weight	Shelf Pack Qty.
18-006	781412180060	Bagged	3/16 in	0.450 in	0.310 in	0.820 in	0.126 in	0.170 in	0.380 in	0.02 lb	1
18-007	781412180077	Bagged	7/32 in	0.450 in	0.345 in	0.820 in	0.126 in	0.170 in	0.380 in	0.03 lb	1
18-008D	781412180084	Bagged	1/4 in	0.450 in	0.390 in	0.820 in	0.141 in	0.180 in	0.380 in	0.02 lb	1
18-009	781412180091	Bagged	9/32 in	0.450 in	0.425 in	0.820 in	0.172 in	0.190 in	0.380 in	0.03 lb	1
18-010	781412180107	Bagged	5/16 in	0.465 in	0.465 in	0.820 in	0.172 in	0.260 in	-	0.02 lb	1
18-011	781412180114	Bagged	11/32 in	0.500 in	0.500 in	0.820 in	0.203 in	0.280 in	-	0.02 lb	1
18-012	781412180121	Bagged	3/8 in	0.555 in	0.555 in	0.820 in	-	0.500 in	-	0.03 lb	1
18-014	781412180145	Bagged	7/16 in	0.615 in	0.615 in	0.820 in	-	0.500 in	-	0.04 lb	1
18-016	781412180169	Bagged	1/2 in	0.680 in	0.680 in	0.820 in	-	0.500 in	-	0.81 lb	1

ARMSTRONG® 1/4" Drive 6 Point SAE Magnetic Power Sockets For Self-Tapping Screws

- Made in the USA - Quality and Availability
- Designed for Use with Electric or Air Driven Power Tools; Not for Use with Impact Power Tools
- Higher Hardness is Designed to Reduce Surface Wear When Used to Turn Hardened Fasteners, Profile with Magnet is Designed Retain and Seat Self-Tapping Screws
- Socket Wall Dimensions Are Optimized to Provide Strength While Retaining Access to Restricted Fasteners
- Manufactured From High Alloy Steel Using the Most Up-To-Date Manufacturing Process and Heat Treat for Greater Strength and Durability

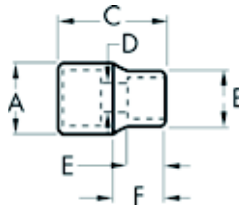

Cat. No.	UPC No.	Packaging	Fastener Size	Dim. A: Drive End	Dim. B: Wrench End	Dim. C: Overall Length	Dim. E: Wrench Depth	Dim. F: Length to Shoulder	Product Weight	Shelf Pack Qty.
18-076	781412180763	Bagged	3/16 in	0.500 in	0.320 in	0.880 in	0.160 in	0.370 in	0.03 lb	1
18-078	781412180787	Bagged	1/4 in	0.500 in	0.380 in	0.880 in	0.160 in	0.370 in	0.03 lb	1
18-080	781412180800	Bagged	5/16 in	0.500 in	0.500 in	1.000 in	0.190 in	-	0.03 lb	1
18-081	781412180817	Bagged	11/32 in	0.500 in	0.500 in	1.000 in	0.190 in	-	0.06 lb	1
18-082	781412180824	Bagged	3/8 in	0.630 in	0.630 in	1.000 in	0.250 in	-	0.06 lb	1
18-084	781412180848	Bagged	7/16 in	0.630 in	0.630 in	1.000 in	0.280 in	-	0.07 lb	1
18-086	781412180862	Bagged	1/2 in	0.680 in	0.680 in	1.000 in	0.340 in	-	0.07 lb	1

ARMSTRONG® 1/4" Drive 6 Point SAE Deep Thin Wall Power Sockets

- Made in the USA - Quality and Availability
- Designed for Use with Electric or Air Driven Power Tools; Not for Use with Impact Power Tools
- Higher Hardness is Designed to Reduce Surface Wear When Used to Turn Hardened Fasteners, Thin Wall Design for Access to Restricted Fasteners
- Socket Wall Dimensions Are Optimized to Provide Strength While Retaining Access to Restricted Fasteners
- Manufactured From High Alloy Steel Using the Most Up-To-Date Manufacturing Process and Heat Treat for Greater Strength and Durability
- Meets or Exceeds ASME B107.3 and US Federal Spec. GGG-W-660A

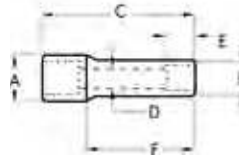

Cat. No.	UPC No.	Packaging	Fastener Size	Dim. A: Drive End	Dim. B: Wrench End	Dim. C: Overall Length	Dim. D: Bolt Clearance	Dim. E: Wrench Depth	Dim. F: Length to Shoulder	Product Weight	Shelf Pack Qty.
18-206	781412182064	Bagged	3/16 in	0.450 in	0.310 in	1.940 in	0.126 in	0.230 in	0.870 in	0.04 lb	1
18-208	781412182088	Bagged	1/4 in	0.450 in	0.388 in	1.940 in	0.172 in	0.219 in	0.870 in	0.06 lb	1
18-209	781412182095	Bagged	9/32 in	0.450 in	0.425 in	1.940 in	0.172 in	0.230 in	0.870 in	0.05 lb	1
18-210D	781412182101	Bagged	5/16 in	0.450 in	0.450 in	1.940 in	0.200 in	0.680 in	-	0.06 lb	1
18-211	781412182118	Bagged	11/32 in	0.500 in	0.500 in	1.940 in	0.250 in	0.680 in	-	0.08 lb	1
18-212	781412182125	Bagged	3/8 in	0.550 in	0.550 in	1.940 in	0.344 in	0.950 in	-	0.08 lb	1
18-214	781412182149	Bagged	7/16 in	0.615 in	0.615 in	1.940 in	0.297 in	0.950 in	-	0.10 lb	1
18-216	781412182163	Bagged	1/2 in	0.680 in	0.680 in	1.940 in	0.344 in	0.950 in	-	0.12 lb	1

1 / 4 "

4

IMPACT SOCKETS

ARMSTRONG® 1/4" Drive 6 Point SAE Impact Sockets

- Made in the USA - Quality and Availability
- Radius Corner Design Engages the Flats of the Fastener, Not the Corners, Providing Up to 15%-20% More Torque While Reducing Fastener Rounding, Enhancing the Turning of Worn Fasteners
- EYE-D™ Markings Optimize Size Visibility, Also Providing SAE / Metric Differentiation
- Socket Wall Dimensions Are Optimized to Provide Strength While Retaining Access to Restricted Fasteners
- Manufactured From High Alloy Steel Using the Most Up-To-Date Manufacturing Process and Heat Treat for Greater Strength and Durability
- Meets or Exceeds ASME B107.2-2002 and US Federal Spec. GGG-W-660A

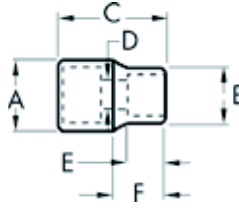

Cat. No.	UPC No.	Packaging	Fastener Size	Dim. A: Drive End	Dim. B: Wrench End	Dim. C: Overall Length	Dim. D: Bolt Clearance	Dim. E: Wrench Depth	Dim. F: Length to Shoulder	Product Weight	Shelf Pack Qty.
18-606	781412186062	Bagged	3/16 in	0.500 in	0.302 in	0.845 in	0.130 in	0.300 in	0.295 in	0.03 lb	1
18-607	781412186079	Bagged	7/32 in	0.500 in	0.338 in	0.845 in	0.190 in	0.300 in	0.295 in	0.03 lb	1
18-608	781412186086	Bagged	1/4 in	0.500 in	0.374 in	0.845 in	0.190 in	0.345 in	0.265 in	0.03 lb	1
18-609	781412186093	Bagged	9/32 in	0.500 in	0.490 in	0.875 in	0.240 in	0.375 in	-	0.04 lb	1
18-610	781412186109	Bagged	5/16 in	0.500 in	0.500 in	0.875 in	0.240 in	0.375 in	-	0.04 lb	1
18-611	781412186116	Bagged	11/32 in	0.530 in	0.530 in	0.875 in	0.240 in	0.375 in	-	0.04 lb	1
18-612	781412186123	Bagged	3/8 in	0.575 in	0.575 in	0.875 in	0.376 in	0.500 in	-	0.05 lb	1
18-614	781412186147	Bagged	7/16 in	0.655 in	0.655 in	0.875 in	0.438 in	0.500 in	-	0.05 lb	1
18-616	781412186161	Bagged	1/2 in	0.725 in	0.725 in	0.875 in	0.501 in	0.500 in	-	0.06 lb	1
18-618	781412186185	Bagged	9/16 in	0.780 in	0.780 in	0.875 in	0.564 in	0.500 in	-	0.03 lb	1
18-620	781412186208	Bagged	5/8 in	0.860 in	0.860 in	1.000 in	0.626 in	0.625 in	-	0.09 lb	1

1 / 4 "

4

I M P A C T S O C K E T S

ARMSTRONG® 1/4" Drive 6 Point Metric Impact Sockets

- Made in the USA - Quality and Availability
- Radius Corner Design Engages the Flats of the Fastener, Not the Corners, Providing Up to 15%-20% More Torque While Reducing Fastener Rounding, Enhancing the Turning of Worn Fasteners
- EYE-D™ Markings Optimize Size Visibility, Also Providing SAE / Metric Differentiation
- Socket Wall Dimensions Are Optimized to Provide Strength While Retaining Access to Restricted Fasteners
- Manufactured From High Alloy Steel Using the Most Up-To-Date Manufacturing Process and Heat Treat for Greater Strength and Durability
- Meets or Exceeds ASME B107.33M-2002

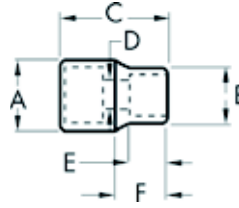

Cat. No.	UPC No.	Packaging	Fastener Size	Dim. A: Drive End	Dim. B: Wrench End	Dim. C: Overall Length	Dim. D: Bolt Clearance	Dim. E: Wrench Depth	Dim. F: Length to Shoulder	Product Weight	Shelf Pack Qty.
45-004	781412450040	Bagged	4 mm	0.500 in	0.264 in	0.846 in	0.126 in	0.299 in	0.295 in	0.03 lb	1
45-005	781412450057	Bagged	5 mm	0.500 in	0.311 in	0.846 in	0.189 in	0.299 in	0.295 in	0.03 lb	1
45-006	781412450064	Bagged	6 mm	0.500 in	0.335 in	0.846 in	0.189 in	0.299 in	0.295 in	0.03 lb	1
45-007	781412450071	Bagged	7 mm	0.500 in	0.358 in	0.846 in	0.189 in	0.346 in	0.264 in	0.03 lb	1
45-008	781412450088	Bagged	8 mm	0.500 in	0.402 in	0.846 in	0.240 in	0.374 in	0.287 in	0.03 lb	1
45-009	781412450095	Bagged	9 mm	0.531 in	0.531 in	0.874 in	0.240 in	0.374 in	-	0.05 lb	1
45-010	781412450101	Bagged	10 mm	0.543 in	0.543 in	0.874 in	0.240 in	0.374 in	-	0.05 lb	1
45-011	781412450118	Bagged	11 mm	0.614 in	0.614 in	0.874 in	0.394 in	0.500 in	-	0.06 lb	1
45-012	781412450125	Bagged	12 mm	0.654 in	0.654 in	0.874 in	0.433 in	0.500 in	-	0.06 lb	1
45-013	781412450132	Bagged	13 mm	0.681 in	0.681 in	0.874 in	0.472 in	0.500 in	-	0.07 lb	1
45-014	781412450149	Bagged	14 mm	0.748 in	0.748 in	0.874 in	0.512 in	0.500 in	-	0.07 lb	1
45-015	781412450156	Bagged	15 mm	0.780 in	0.780 in	0.874 in	0.551 in	0.500 in	-	0.09 lb	1
45-083	781412450835	Bagged	5.5 mm	0.850 in	0.850 in	1.000 in	0.591 in	0.626 in	-	0.03 lb	1

1 / 4 "

4

IMPACT SOCKETS